

C'treat

— An ITT Brand

oustabout[™] Rentals

Reverse Osmosis Watermakers for
the Marine and Offshore Market



Roustabout LV



Mechanical

- Product Flow – Up to 6,000 USgpd (22 m³/day)
- Meets World Health Org. (WHO) standard (<500 ppm TDS)
- 1st Stage Filtration – 5 micron
- 2nd Stage Filtration - 1 micron (for extended membrane life)
- Spiral wound thin film composite membrane elements
- Pump Construction - Duplex/Super Duplex Stainless Steel
- Pump Feature – Self-Lubrication Oil Free Design
- Required Feed Rate – 9.9 USgpm (2.25 m³/hr)

Electrical

- Designed for Class 1, Div. 2, Group B, C, and D
- NEMA 7/4X Motor Starter Box
- NEMA 4X PLC Control Panel Box (non-arcing or sparking)
- 10 HP (7.5 kW) - 480 V / 3ph / 60Hz - NEMA Premium Efficiency Motor
- TEFC IP55 Motor Enclosure

Structural

- Dimensions - 71 in. (1.80 m) / 32 in. (0.81 m) / 76 in. (1.93 m)
- Top Corner Lifting Lugs / Forklift Pockets / Liquid Containment Base
- Sch. 80 316L Stainless steel high pressure pipe / Sch. 80 PVC Low pressure pipe
- Carbon Steel Frame with three coat epoxy paint
- Weight - 2,500 lbs (1,133 kg)

*Testing - ISO 9001-2015 Standard, ITT C'treat, LLC , The Woodlands, Texas USA

Roustabout HV



Mechanical

- Product Flow - 6,000 USgpd (22 m³/day) - 22,000 USgpd (83.3 m³/day)
- Meets World Health Org. (WHO) standard (<500 ppm TDS)
- 1st Stage Filtration – 5 micron
- 2nd Stage Filtration - 1 micron (for extended membrane life)
- Spiral wound thin film composite membrane elements
- Pump Construction - Duplex/Super Duplex Stainless Steel
- Pump Feature – Self-Lubricating Oil Free Design
- Required Feed Rate – 44 USgpm (10 m³/hr)

Electrical

- Designed for Class 1, Div. 2, Group B, C, and D
- NEMA 4X PLC Panel Box with motor starter (NFPA 496 Type)
- 30 HP (22 kW) - 480 V / 3ph / 60Hz - NEMA Premium Efficiency Motor
- TEFC IP55 Motor Enclosure

Structural

- Dimensions - 108 in. (2.74 m) / 46 in. (1.17 m) / 83.5 in. (2.12 m)
- Top Corner Lifting Lugs
- Sch. 80 316L Stainless steel high pressure pipe / Sch. 80 PVC Low pressure pipe
- Carbon Steel Frame with three coat epoxy paint
- Weight - 3,100 lbs (1,410 kg)

*Testing - ISO 9001-2015 Standard, ITT C'treat, LLC , The Woodlands, Texas USA

Visit our website at
www.ctreat.com or call 281.367.2800

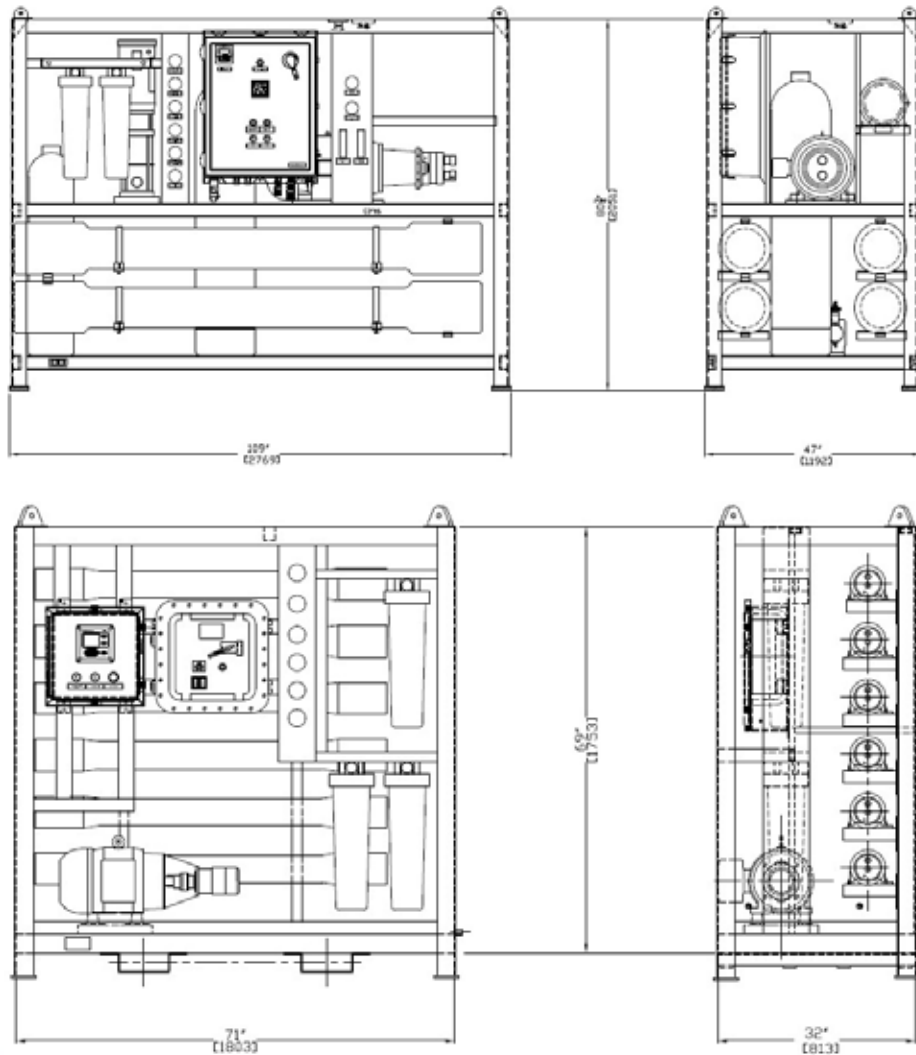

On-Skid Options:

- Chlorine disinfection - post treatment
- pH neutralization – post treatment
- Booster pump – supplementary inlet line pressure

Off-Skid Options:

- Automatic Backwash Media Filter – For removal of heavy solids and chlorine
- Ultraviolet Sterilizers
- Pressure Sets

ctreat

An ITT Brand